

# Full Spectrum Sanctuary Retreat by Clearlight®



## Features

### Therapeutic Far Infrared Heaters

Clearlight's exclusive True Wave® Far Infrared heaters are the only patented low EMF full spectrum heaters on the market. True Wave combination carbon/ceramic low EMF / low ELF heaters surround you in healing infrared heat.

### True Wave® Full Spectrum Heaters

Our full spectrum near, mid and far infrared heaters deliver over 20 times the power of the nearest leading competitor. Our patented heating system allows for the deepest penetration with peak performance for the best results.

### Two Removable Benches

Relax in comfort with two removable 34 1/4" benches or remove the benches for easy wheelchair access.

### Italian Inspired Design & Glass Roof

The open feel and beautiful design of your Sanctuary sauna will compliment every room.

### Beautiful Accent Lights

Energy efficient LED lights highlight the beauty of your sauna while providing gentle ambient lighting.

### Charging & Audio Station

Charge your smart device inside the sauna and connect your favorite audio device with Bluetooth or the included MP3 jack.

### Wheelchair Accessibility Features

Our sauna is equipped with a strong hemlock wood ramp for wheelchair access. The 36" wide door is taller for easy entry, and features a lower keypad for convenient use, along with wheelchair-friendly wood and steel handles designed to enhance accessibility when utilizing removable benches. Please check national & local requirements for accessibility compliance before purchasing.

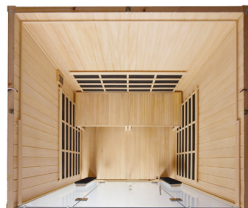

### Enhanced Audio Sound System

Bluetooth and AUX inputs makes it easy to connect and listen to your audio devices.



### Digital Keypad Controls

Digital keypad controls temperature, time, lights, heater intensity and reservation mode.



### Chromotherapy

Your Sanctuary sauna comes upgraded with our therapeutic Chromotherapy. Choose from one of twelve colors or auto-cycle through all color tones.

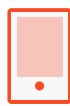

### Smart Device Control (Optional)

Log in from your smart device and remotely operate your sauna.

# Full Spectrum Sanctuary Retreat by Clearlight®

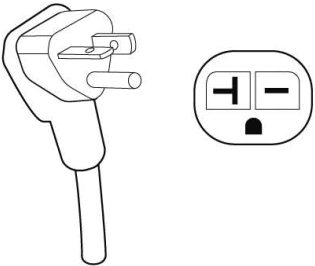
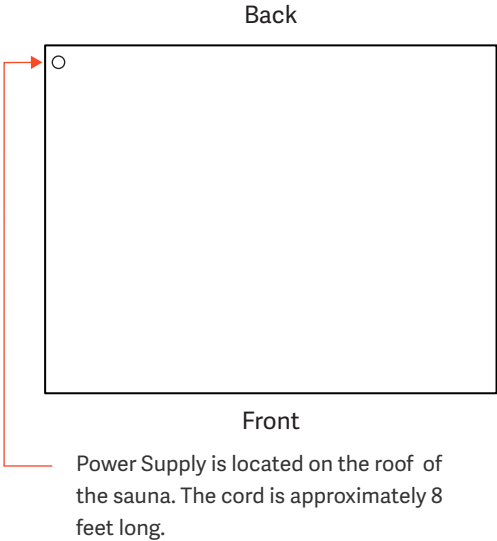
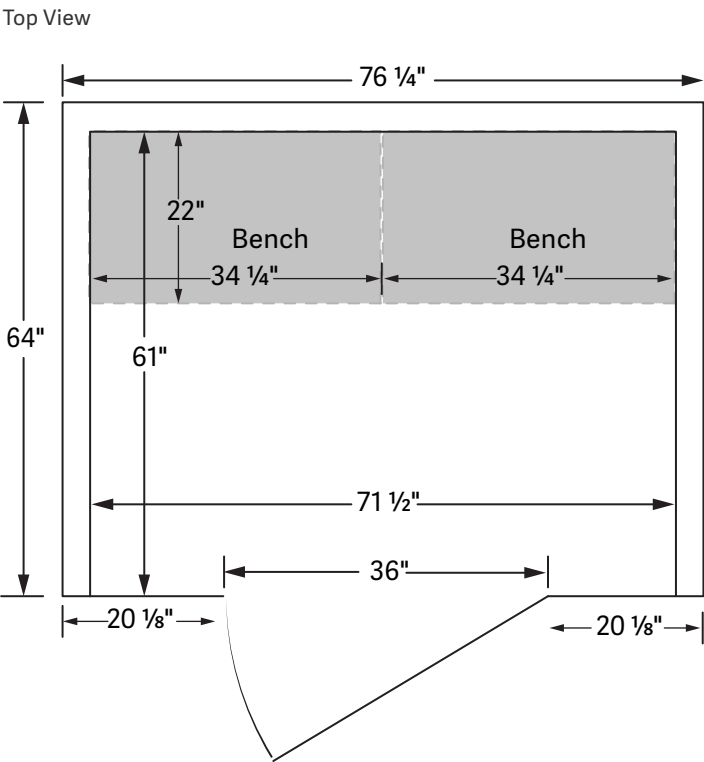
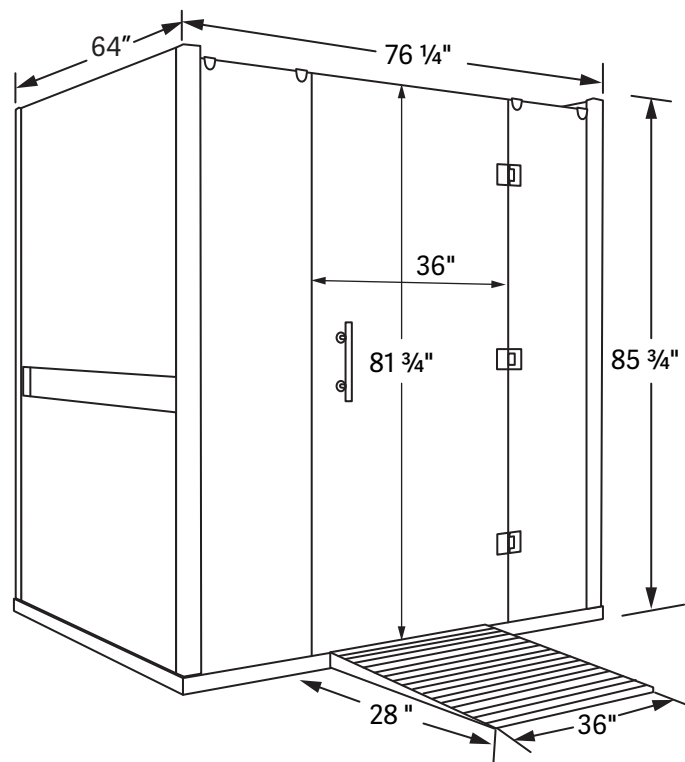

## Specifications

Construction	Exterior	Interior	Ramp	Heaters	Limited Lifetime Residential & 5 Year Commercial Warranty	Attention: Make sure largest panel can fit through all access points from location entrance to sauna set up location
Eco-Certified wood choices: Mahogany Exterior/Interior Basswood Exterior/Interior Tongue & Groove Construction Weight: 780 lbs	Width: 76 1/4" Depth: 64" Height: 85 3/4" Door Opening: 36" x 81 3/4"	Width: 71 1/2" Depth: 61" Height: 82 3/4" Two Benches: 34 1/4" x 22" Bench Height: 19 1/4"	Width: 36" Depth: 28" Elevated Height: 2 1/2" Bottom Height: 1/4" Slope: 3.136°	True Wave® Carbon/Ceramic Far Infrared and Full Spectrum Heaters Power: 240V / 3,610W / 15.1A	Cabinetry & Glass Electrical Heaters Controls	!!

# Full Spectrum Sanctuary Retreat by Clearlight®

Individual panel sizes laying flat in inches

Panel	Length	Width	Height
Roof	33	72	3
Floor	64 ½	76 ¾	2 ¼
Left Side	84	64 ¼	3 ½
Right Side	84	64 ¼	3 ½
Back Wall	84	71 ½	4 ¼

## Electrical Wire Requirements:

20 amp saunas are 12 AWG  
Single Phase / 3 wire: 2 x live/ground - for 240v



For specific recommendations on which wheelchairs are compatible with your Infrared Sauna, please reach out to your Clearlight Infrared Sauna Specialist.

We advise against using battery-operated wheelchairs inside the sauna, as the heat can affect the battery performance.

## Additional Information

### Installation and Clearance Requirements

Your sauna is designed as a standalone unit and must remain fully accessible on all sides and the roof. **At least 4 inches (10 cm) minimum clearance** on each side of the sauna is required for installation and proper ventilation. **Adequate clearance above the sauna roof** is necessary to allow for installation, troubleshooting, and maintenance access as key components are located in the roof of the sauna. Please ensure sufficient space to safely access the roof when needed.

### Glass Roof

W: 71 ½" D: 28 ½" H: 8mm

### Removable Bench Placement Recommendation

Maintain a minimum distance of 18 inches (46 cm) between removable benches and front heaters to ensure proper performance and safety compliance.

### Bench Weight Limit

350 lbs per person

### Add On

- Can't have both upgrade heater and Red Light simultaneously
- Not VRT compatible
- No Charging Cubby

### Surface Requirements

Make sure sauna is placed on a level surface