



END-USER INSTRUCTIONS

CUSTOMIZING YOUR HOME SYSTEM

The perfect home technology setup looks different for everyone. We always try our best to set you up with a system tailored to your specific lifestyle and preferences, but realistically, we can't always account for everything. Additionally, routines are dynamic and shift over time, and your system should be able to flex along with you.

Crestron Home OS is continually evolving to give you more flexibility and customization with your system. The following guide outlines ways you can make more advanced and custom changes to your system yourself - without even needing to contact us!

And...don't worry, you really can't break anything!

CHANGE ROOM + HOME IMAGES

Instantly update the look and feel of your system by customizing images for both individual Rooms and the main Home tab.

- 1 Navigate to the desired Room or to the main Home tab.
- 2 Select the "..." button in the upper right corner of the screen, then select "Change Image".
- 3 Choose from Crestron stock photos, your personal Gallery, or take a new photo! NOTE: Taking a photo directly from the Crestron app does NOT save it to your Gallery.

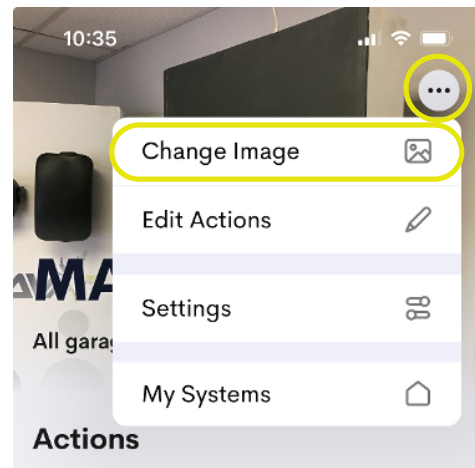

NOTE: This must be performed on the app (not Touch Panels), but the images will instantly update across all interfaces. Room and Home images are system-wide and cannot be customized on individual devices.

RENAME ROOMS

Do you refer to a space differently than we originally set it up? Rename the room!

- 1 Navigate to the desired Room.
- 2 Select the "..." button in the upper right corner of the screen, then select "Rename Room".

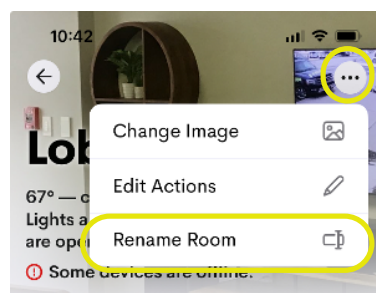

NOTE: Can be done on the app OR Touch Panels. Room names are system-wide and cannot be customized on individual devices.



END-USER INSTRUCTIONS

CUSTOMIZING YOUR HOME SYSTEM

QUICK ACTIONS: EDIT ICONS + REORDER

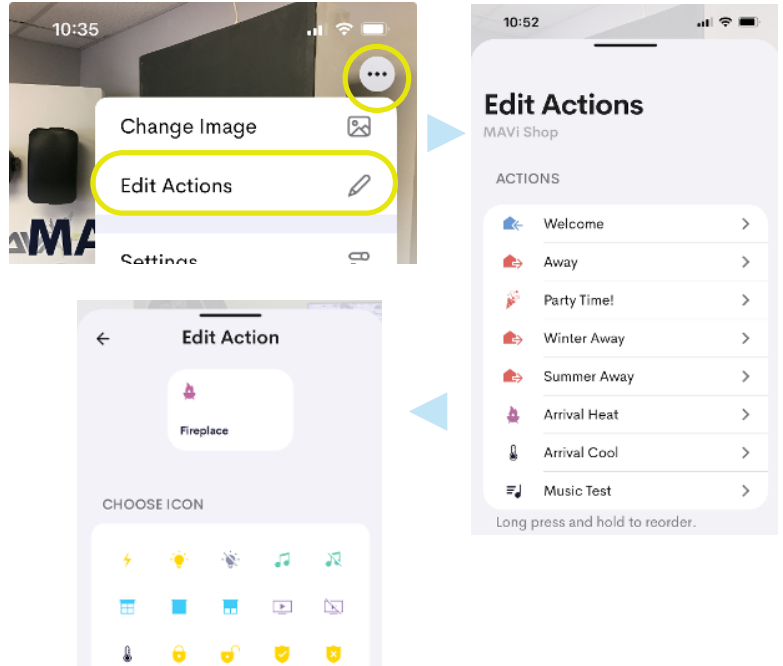

Though the defaults may work, modifying Quick Action icons and reordering them adds a deeper level of customization to your app and Touch Panel experience.

- 1 Navigate to the desired Room or to the main Home tab.
- 2 Select the "... " button in the upper right corner of the screen, then select "Edit Actions".
- 3 To change a Quick Action icon, select the desired action, then choose from the icon options.
- 4 To reorder Quick Actions from alphabetical to a more useful order, long press + hold on an action in the list and drag up or down.

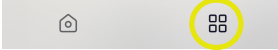

CUSTOMIZE YOUR ROOM LIST

Do you prefer detailed information about your system or a quick glance? Are there common Rooms you use all the time? Customize your Room list!

- 1 Navigate to the Rooms list by selecting the Rooms tab at the bottom. 
- 2 Toggle between more compact and more detailed room tiles with the button in the **upper right corner**.  
- 3 Add Rooms to your **Favorites** by selecting the heart icon on the room tile. Access your Favorites list at the top.

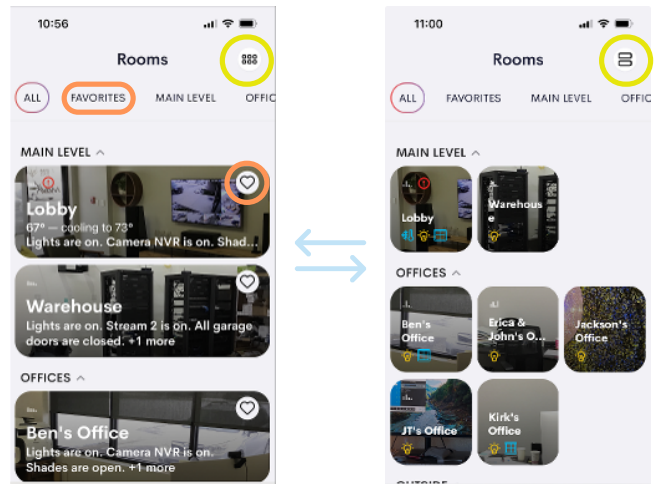

NOTE: This is performed on an individual device-by-device basis. Different interfaces can have different Favorites and tile sizes.



END-USER INSTRUCTIONS

CUSTOMIZING YOUR HOME SYSTEM

SCENES: ADD, EDIT, + REORDER

Scenes are an incredibly useful tool for recalling specific Lighting and Shades looks with preset level settings. Modify any Scenes we created for you, or make your own!

WHOLE HOUSE LIGHTING SCENES

1

Navigate to the main Home tab along the bottom, then the Lights tile.

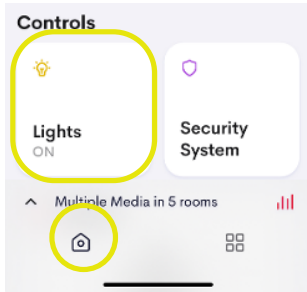

NOTE: Modifying Scenes that are programmed to Quick Actions and/or keypad buttons WILL update the levels recalled by those.

2

Select the Scenes tab along the top, then the pencil icon to edit. Choose from the menu to Create New, Edit, or Reorder scenes.

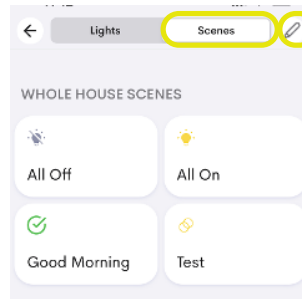

NOTE: Modifying the default "All On" and "All Off" scenes will also update the behavior of the toggle buttons on the Lights tile.

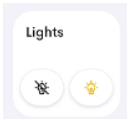

3

To **rename the scene** and/or **select an icon**, tap the Scene button bubble at the top.

4

To **add lights to the Scene**, select "+ Add Lights", then navigate through the list of rooms that have lighting. Then, check the boxes next to any lighting loads you wish to include in the Scene (or uncheck boxes to exclude loads).

Excluded loads are unaffected by the Scene and will remain in their current states when the Scene is recalled.

5

To **adjust lighting levels** of any lights included in the scene, select the bubbled lists of lighting loads and adjust the sliders to the desired states.

6

Choose which Rooms you wish to display the scene in using **Scene Visibility**.

7

Choose the duration of time (in seconds) the Scene will take to fade using **Fade Time**.

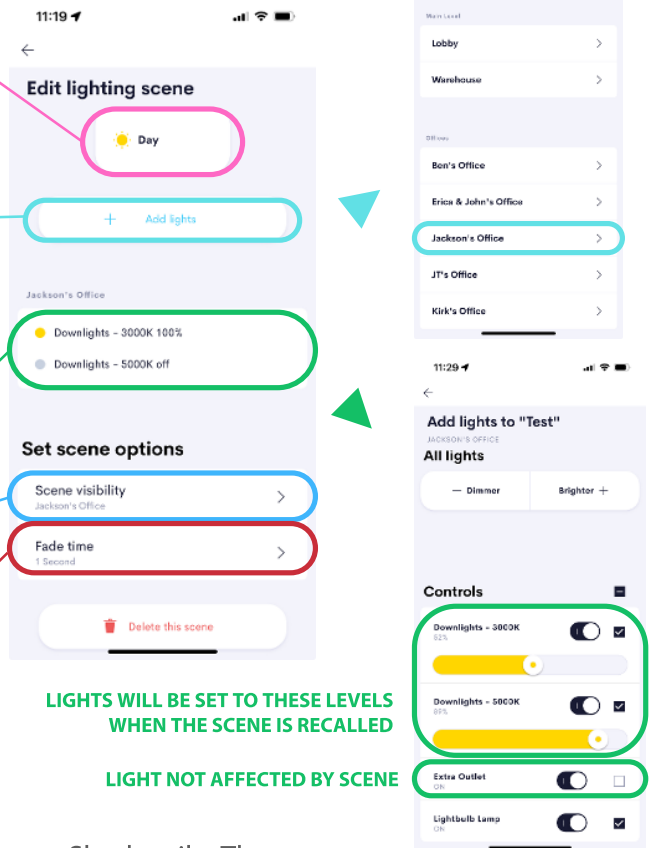

LIGHTS WILL BE SET TO THESE LEVELS WHEN THE SCENE IS RECALLED

LIGHT NOT AFFECTED BY SCENE

ROOM LIGHTING + SHADE SCENES

1

Navigate to the desired Room tile, then select the Lights or Shades tile. The pencil icon is available in the upper right corner. Follow Steps 3-7 above.



END-USER INSTRUCTIONS

CUSTOMIZING YOUR HOME SYSTEM

EDIT SCHEDULED EVENTS

Put the "Automation" in Home Automation System by taking advantage of Scheduled Events - make routine Lighting and Shading scenes recur automatically.

1 Navigate to the main Home tab along the bottom, then to the "..." icon in the upper right corner. Choose "Settings" > "Scheduled Events".

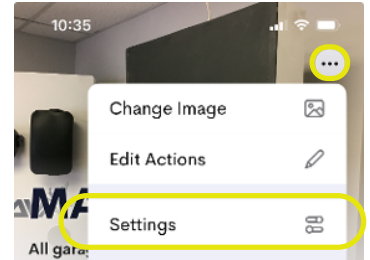

2 Create a new Scheduled Event using the "+" icon in the upper right corner, or select an existing Schedule to edit.

3 To **rename the Schedule**, type in the "Name" field.

4 Use the toggle switch to **Enable or Disable** the schedule. Enabled schedules will occur at their set times. Disabled schedules will NOT run (allowing you to preserve programming for future use).

5 **Select the time** at which you'd like the Schedule to occur. **Schedules can only occur at one time per day.** **TIP:** Create a second schedule to reverse actions triggered by the first, e.g., turning lights back off at another time.

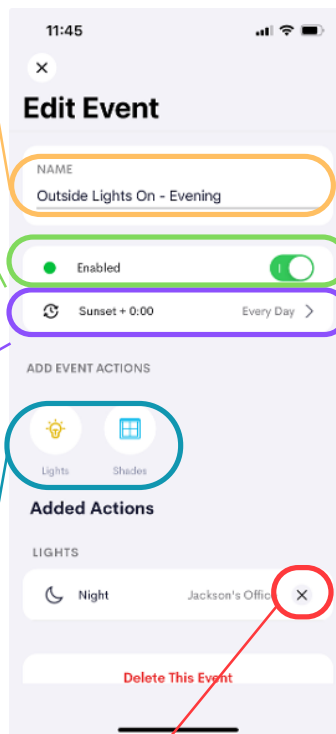

Times can be based on a fixed clock time (e.g., 6:00 PM) or based on Astronomical timeclock (shifting each day with Sunset or Sunrise time). Schedules can also be run on specific days of the week.

6 Tell the Schedule what to do at the set time. Schedules operate by triggering Scene(s). **Select the Lights or Shades buttons** to add Scene(s).

TIP: To edit the behavior of the Schedule, go find the triggered Scene(s) in their respective Rooms' Lights or Shades tiles and edit them using the steps on the previous page. Want new functionality? Create your own Scenes to trigger!

7 **Remove any currently selected Scenes** using the "X". You cannot remove Scenes from the same screen where you add them.

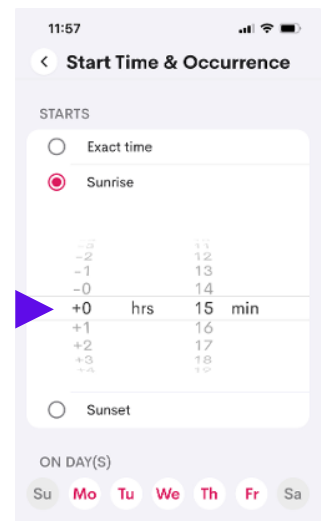

TIP: Create separate Schedules for functionalities with different purposes, enabling you to easily make tweaks in the future. For example, create separate On and Off schedules for Outdoor Lights, Indoor Lights, and Christmas Lights so times can be flexibly adjusted and certain schedules can be Enabled and Disabled.

NOTE: Scheduling functionality only available if your Processor has been updated to OS4 or later. If this has not been done, the "Edit Scheduled Events" option will not be available. Contact MAVi for assistance.

NOTE: As an end-user, you are unable to schedule systems other than Lights and Shades (e.g., Audio, Video, Door Locks, Garage Doors). Contact MAVi for help scheduling these systems.



END-USER INSTRUCTIONS

CUSTOMIZING YOUR HOME SYSTEM

CLIMATE: CREATE + ADJUST SCHEDULES

If your home has climate control integrated into your system, manage climate schedules without even having to go to a thermostat!

1

Navigate to the main Home tab and select the Climate tile, then the desired thermostat; or navigate to a Room containing a thermostat and select it.

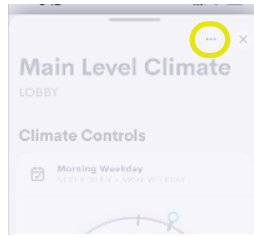

2

In the upper right corner within a thermostat, select "... > "Scheduled Events".

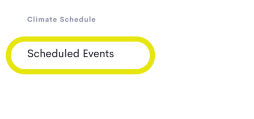

3

Select an existing Scheduled Event to edit, or create a new one with the **" + Create New Scheduled Event"** button. **TIP:** Schedules that are greyed out are currently disabled.

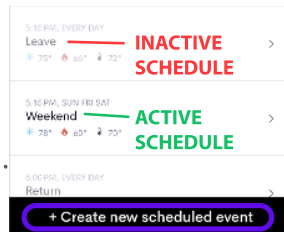

4

Name the schedule as needed. Then, select the days you'd like it to run, and the start time. **TIP:** Schedules will run until another Schedule or manual operation overrides them.

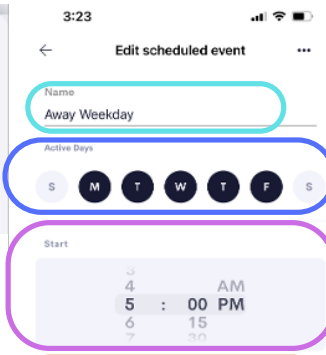

5

Set the various set points as desired. **NOTE: The thermostat will run to the appropriate respective set point based on the operation mode the thermostat is in when the Schedule's trigger time occurs.**

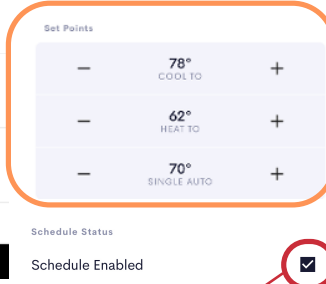

6

Check the box to **Enable or Disable the Schedule.** Similarly to Lights and Shades, Disabled Schedules will NOT run (but allow you to preserve programming for future recall). **TIP:** It is often easiest to create dedicated Summer and Winter Schedules and Enable/Disable them seasonally.



For example, if this thermostat is in cooling mode, it will cool to 78° starting at 5:00pm on weekdays. If it is in heating mode, it will start heating to 62° at 5:00pm.

AUDIO INTERRUPTS + CHIMES

If you have compatible equipment, your Home system can notify you when doors are unlocked or opened, alarms are activated, or other select events occur.

1

Navigate to the main Home tab along the bottom, then to the "... icon in the upper right corner. Choose "Settings" > "Scheduled Events" > "App Customizations" > scroll to bottom > "Events & sounds".



2

Select a trigger device for which you'd like to customize the notification sound > select "... > choose a sound from the list. **TIP:** Use a touch panel to browse sound options as they will preview the sounds when selected.

3

Toggle the switches on and off to enable or disable notification sounds on the specific device you're using.

NOTES:

- Notification sounds for a given trigger device apply to all interfaces in the system (touch panels and app).
- Notification toggle switches are DEVICE-SPECIFIC (can have different settings per touch panel and personal device).
- Personal devices only play notification sounds when the device is unlocked and the app is actively open.