

LIVING STONE CONCRETE DESIGN[®]

STANDARD SINK SIZE GUIDE

We offer five standard sink shapes for your selection. If you require a size other than our standard dimensions, please specify the style and custom size and we will provide pricing for a custom mold accordingly.

Sinks can be made as the following options:
integrated with a countertop, drop-in, vessel, or floating

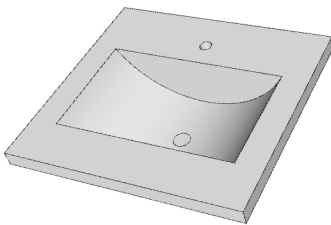

BARREL SINK
Sloped sides. Center drain.

MEASUREMENTS
18.5" (L) x 11" (W) x 5" (D)

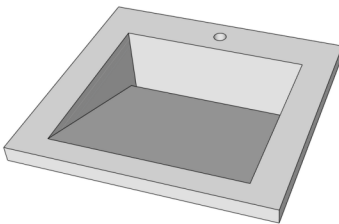

RAMP SINK
Sloped interior in place of a bowl. Linear drain at back.

MEASUREMENTS
18" (L) x 16" (W) x 6" (D)

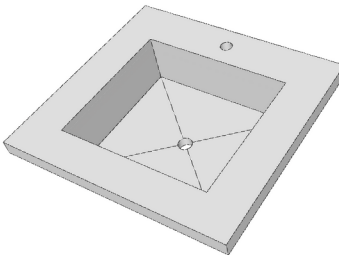

TROUGH SINK
Slightly sloped for drainage. Flat bottom. Center drain.

MEASUREMENTS
16" (L) x 14" (W) x 5.5" (D)

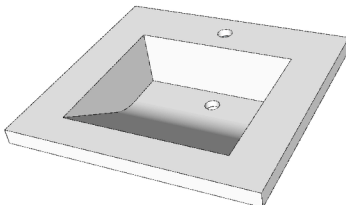

HALF-TROUGH SINK
Sloped front. Center-back drain.

MEASUREMENTS
16" (L) x 14" (W) x 5.5" (D)

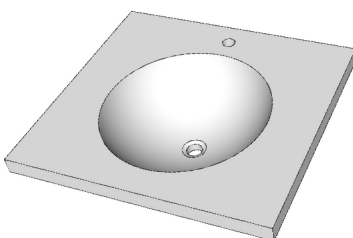

ROUND SINK
Half circle bowl. Center drain.

MEASUREMENTS
15.25" (dia) x 5" (D)