

Malcom Bridge Estates

Oconee County's Newest Community



MalcomBridgeEstates.com

2201 Malcom Bridge Road
Bogart, GA 30622

****Information contained herein is deemed reliable but not guaranteed and subject to change****

Malcom Bridge Estates

Malcom Bridge Estates is Oconee County's newest gated community. This neighborhood features 74 vacant lots that offer a blank canvas for you to curate your dream home on. Nestled in North Oconee, this location is incredibly convenient and minutes from all that Athens and Watkinsville have to offer, yet feels tucked away. This community features a gated entrance and a community pool. The lots ranging from 0.69 acres to 3.89 acres with pricing ranging from \$200,000 to \$400,000. Whether you are wanting to craft your ideal home on an open meadow, a wooded lot, creekfront or a combination, Malcom Bridge Estates has a lot that is perfect for you.



UNDER CONTRACT



UNDER CONSTRUCTION



SOLD

Malcom Bridge Estates

PRICING:

Lot	Address	Acres	Sales Price	Lot	Address	Acres	Sales Price
1	1160 Malcom Estates Drive	0.83	Reserved	38	1381 Malcom Estates Ridge	0.77	\$200,000
2	1230 Malcom Estates Drive	0.76	Reserved	39	1283 Malcom Estates Ridge	0.99	\$210,000
3	1360 Malcom Estates Drive	0.74	SOLD	40	1183 Malcom Estates Drive	Amenity Lot	
4	1496 Malcom Estates Drive	0.73	Reserved	41	1365 Malcom Estates Ridge	0.82	\$200,000
5	1628 Malcom Estates Drive	0.76	Reserved	42	1136 Malcom Estates Ridge	0.69	Reserved
6	1762 Malcom Estates Drive	0.78	SOLD	43	1741 Malcom Estates Drive	0.74	\$215,000
7	1934 Malcom Estates Drive	0.89	UNDER CONSTRUCTION	44	1873 Malcom Estates Drive	0.71	Reserved
8	2114 Malcom Estates Drive	0.93	UNDER CONSTRUCTION	45	1983 Malcom Estates Drive	0.70	Reserved
9	2262 Malcom Estates Drive	0.77	Reserved	46	2125 Malcom Estates Drive	0.72	Reserved
10	2434 Malcom Estates Drive	1.21	SOLD	47	2275 Malcom Estates Drive	0.73	Reserved
11	2528 Malcom Estates Drive	1.95	SOLD	48	2527 Malcom Estates Drive	0.80	Reserved
12	2620 Malcom Estates Drive	2.00	\$235,000	49	1121 Malcom Estates Court	0.75	Reserved
13	2880 Malcom Estates Drive	1.02	\$225,000	50	1285 Malcom Estates Court	0.70	Reserved
14	3028 Malcom Estates Drive	1.32	SOLD	51	1431 Malcom Estates Court	0.70	Reserved
15	3164 Malcom Estates Drive	1.06	SOLD	52	1571 Malcom Estates Court	0.74	Reserved
16	3280 Malcom Estates Drive	1.21	\$225,000	53	1651 Malcom Estates Court	0.75	Reserved
17	3608 Malcom Estates Drive	1.70	SOLD	54	1646 Malcom Estates Court	0.98	Reserved
18	1710 Whistling Creek Crossing	1.52	\$300,000	55	1514 Malcom Estates Court	0.83	SOLD
19	1882 Whistling Creek Crossing	2.26	SOLD	56	1370 Malcom Estates Court	0.83	Reserved
20	1835 Whistling Creek Crossing	1.86	\$375,000	57	1218 Malcom Estates Court	0.70	Reserved
21	1715 Whistling Creek Crossing	1.79	\$375,000	58	1104 Malcom Estates Court	0.73	Reserved
22	1585 Whistling Creek Crossing	3.21	SOLD	59	3287 Malcom Estates Drive	0.95	Reserved
23	3810 Malcom Estates Drive	3.34	UNDER CONTRACT	60	3485 Malcom Estates Drive	0.99	Reserved
24	3878 Malcom Estates Drive	3.37	SOLD	61	3665 Malcom Estates Drive	0.90	Reserved
25	3273 Malcom Estates Ridge	2.37	\$350,000	62	3032 Malcom Estates Ridge	1.17	Reserved
26	3063 Malcom Estates Ridge	3.89	\$375,000	63	1147 Malcom Estates Point	0.87	\$1,009,000
27	2909 Malcom Estates Ridge	1.83	SOLD	64	1297 Malcom Estates Point	0.96	UNDER CONSTRUCTION
28	2789 Malcom Estates Ridge	1.36	SOLD	65	1375 Malcom Estates Point	1.08	SOLD
29	2653 Malcom Estates Ridge	1.06	\$225,000	66	1348 Malcom Estates Point	0.78	SOLD
30	2531 Malcom Estates Ridge	1.27	SOLD	67	1224 Malcom Estates Point	0.78	Reserved
31	2417 Malcom Estates Ridge	1.22	SOLD	68	1106 Malcom Estates Point	0.75	Reserved
32	2305 Malcom Estates Ridge	1.13	SOLD	69	2266 Malcom Estates Ridge	0.99	Reserved
33	2141 Malcom Estates Ridge	1.96	\$325,000	70	2080 Malcom Estates Ridge	0.98	Reserved
34	1953 Malcom Estates Ridge	0.89	\$200,000	71	1902 Malcom Estates Ridge	0.83	Reserved
35	1797 Malcom Estates Ridge	0.76	\$200,000	72	1764 Malcom Estates Ridge	0.69	Reserved
36	1657 Malcom Estates Ridge	0.76	SOLD	73	1654 Malcom Estates Ridge	0.69	Reserved
37	1511 Malcom Estates Ridge	0.84	\$1,099,000	74	1544 Malcom Estates Ridge	0.69	Reserved
				75	1372 Malcom Estates Ridge	0.89	Reserved

Information contained herein is deemed reliable but not guaranteed and subject to change

LOT #37

\$1,099,000



1511 MALCOM ESTATES RIDGE
BOGART, GA 30622

PROPERTY FEATURES:



4 Bedrooms



4.5 Bathrooms



Unfinished Basement



0.84 Acres

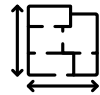

3,471 Sq Ft

ABOUT:

Introducing 1511 Malcom Estates Ridge — a meticulously crafted all-brick home in the exclusive gated community of Malcom Bridge Estates. Located in Oconee County's award-winning North Oconee school district, this four-bedroom, four-and-a-half-bath residence offers 3,471 square feet of thoughtfully designed living space with a large unfinished basement on a beautifully landscaped 0.84-acre lot. Step through the front door into the heart of the home—a spacious two story great room featuring a large fireplace, custom built-ins, and an abundance of natural light from the skylights above. The open-concept kitchen is complete with a large island, high-end cabinetry, custom floating shelves, and designer selections throughout. A vaulted keeping room just off the kitchen offers flexibility as a potential office, formal dining room, sunroom, or additional sitting room space. The main-level owner's suite features dual vanities, a soaking tub, a tile walk-in shower, and an oversized walk-in closet. The main floor has an additional bedroom and en suite bathroom. Upstairs, there are two additional bedrooms and an oversized bonus room all with generous closet space. The unfinished basement (2,314 sq ft) offers plenty of room to grow or customize. The oversized covered porch extends the living space outdoors overlooking the spacious backyard—ideal for relaxing, entertaining, or enjoying the surroundings. With convenient access to Hwy 316, Hwy 78, and Hwy 441, this home combines location, luxury, and livability in one of Oconee County's most desirable neighborhoods.

LOT #63

\$1,009,000



1147 MALCOM ESTATES POINT
BOGART, GA 30622

PROPERTY FEATURES:



4 Bedroom



3.5 Bathroom



0.87 Acres



3,427 Sq Ft



3 Car Garage

ABOUT:

Introducing 1511 Malcom Estate Ridge — a meticulously crafted all-brick home in the exclusive gated community of Malcom Bridge Estates. Located in Oconee County's award-winning North Oconee school district, this four-bedroom, four-and-a-half-bath residence offers 3,471 square feet of thoughtfully designed living space with a large unfinished basement on a beautifully landscaped 0.84-acre lot. Step through the front door into the heart of the home — a spacious two story great room featuring with a large fireplace, custom built-ins, and an abundance of natural light from the skylights above. The open-concept kitchen is complete with a large island, high-end cabinetry, custom floating shelves, and designer selections throughout. A vaulted keeping room just off the kitchen offers flexibility as a potential office, formal dining room, sunroom, or additional sitting room space. The main-level owner's suite features dual vanities, a soaking tub, a tile walk-in shower, and an oversized walk-in closet. The main floor has an additional bedroom and en suite bathroom. Upstairs, there are three additional bedrooms and an oversized bonus room all with generous closet space. The unfinished basement (2,314 sq ft) offers plenty of room to grow or customize. The oversized covered porch extends the living space outdoors overlooking the spacious backyard—ideal for relaxing, entertaining, or enjoying the surroundings. With convenient access to Hwy 316, Hwy 78, and Hwy 441, this home combines location, luxury, and livability in one of Oconee County's most desirable neighborhoods.

Malcom Bridge Estates

ADDITIONAL INFORMATION:

DOCUMENTS

- Final Plat
- Soil Map
- HOA Covenants
- Design Guidelines

UTILITIES

- Water: Oconee County
- Electric: Walton EMC
- Sewer: Septic Tank
- Gas: Atlanta Gas
- Internet: AT&T Fiber

SCHOOL DISTRICT

- Malcom Bridge Elementary School
- Malcom Bridge Middle School
- North Oconee High School

Malcom Bridge Estates

CONTACT INFORMATION:



Leighton Faulkner, REALTOR®

Woodall Realty Group

Brokered by eXp Realty LLC

Mobile: (678)-314-8909

Office: (888)-959-9461

Email: leighton@woodallrealtygroup.com

www.woodallrealtygroup.com

Stephen Smith, REALTOR®

Coldwell Banker Upchurch Realty

Mobile: (706)-248-8175

Office: (706)-543-4000

Email: stephen.athens@yahoo.com

www.upchurchrealty.com

