

Video: how to use this guide and understand the decisions behind it

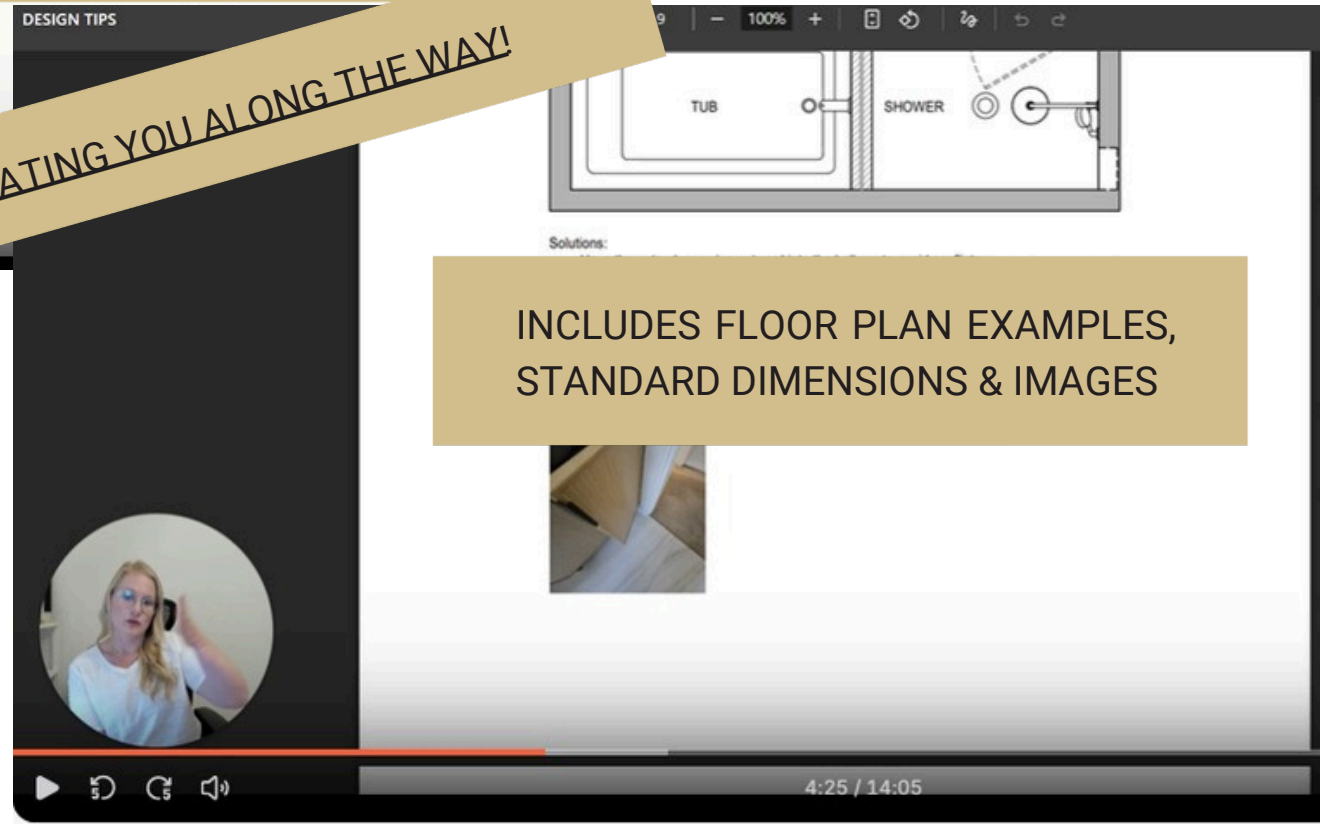

EDUCATING YOU ALONG THE WAY!



Video: Tip on how to avoid costly renovation mistakes





See how all materials work together before you commit

Material Board 4-piece bathroom cost-effective

Floor Plan



Includes both 3-piece (tub/shower, single vanity, toilet) and 4-piece (separate tub and shower, double vanity, toilet) layout options

This sample shows the 4-piece version

*Vanity
Elevation*

Every finish clearly shown so nothing is left to guess

This sample shows the cost-effective version. A custom upgrade option is also included.



Tub &
Shower
Elevation

See exactly how your tub and shower come together before
construction

This sample shows the cost-effective version. A custom upgrade option is also included.

Perspective

This is just a preview.
Your full package includes much more detail.

This sample shows the cost-effective version. A custom upgrade option is also included.

CABINETS/ VANITY

IMAGE

PRODUCT DETAILS

SUPPLIER CONTACT

NOTES



Direct product links, model numbers, and supplier contacts for every item.

Includes both a cost-effective option and an upgraded version so you can choose what fits your budget

TILES

IMAGE

PRODUCT DETAILS

SUPPLIER CONTACT

NOTES

Shower

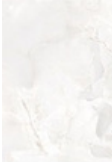

Product links, model numbers, and supplier contacts for every tile.

Includes install notes, edge details, and layout guidance
The questions your contractor will ask — already answered

Stack wall tiles vertically.
The grout lines between wall tiles and flooring must be lined up.

PLUMBING FIXTURES

IMAGE	PRODUCT DETAILS	SUPPLIER CONTACT	NOTES
-------	-----------------	------------------	-------

Vanity Sink F



Shower Fo



Tub Fauc



Shower B



All plumbing fixtures specified
and ready to order

Includes finish selections, model numbers, and supplier details

PLUMBING FIXTURES

IMAGE

PRODUCT DETAILS

SUPPLIER CONTACT

NOTES

Tub







Toilet



*All plumbing fixtures specified
and ready to order*

Includes finish selections, model numbers, and supplier details

PLUMBING ACCESSORIES

IMAGE	PRODUCT DETAILS	SUPPLIER CONTACT	NOTES
 <p>24" Towel Bar</p>	<p>Every detail accounted for</p> <p>Accessories, finishes, and placement all specified for a complete look</p>	Eaton (Supplier Contact)	
 <p>Hand Towel Bar</p>			
 <p>Toilet Paper Holder</p>			
 <p>Towel Holder</p>			

GLASS & MIRROR

IMAGE

PRODUCT DETAILS

SUPPLIER CONTACT

NOTES

Mirror



Shower Sur

Shower H



Shower Har



Shower glass, mirror, and hardware selections
clearly defined

LIGHTING AND ELECTRICAL

IMAGE

PRODUCT DETAILS

SUPPLIER CONTACT

NOTES

Recessed Po



Recessed Po
Wet Area - Insic



Bathroom



Bath Fan T



Product URL links, model numbers, and manufacturer contact info for every item.

LIGHTING AND ELECTRICAL

IMAGE

PRODUCT DETAILS

SUPPLIER CONTACT

NOTES

Cove



Rece



Swi



Wall

Product URL links, model numbers, and manufacturer contact info for every item.

ELECTRICAL SCHEDULE

PAINT, MOULDINGS, DOOR AND DOOR HARDWARE

IMAGE

PRODUCT DETAILS

SUPPLIER CONTACT

NOTES

Wall, Ceiling



Interior



Door T



Product URL links, model numbers, and manufacturer contact info for every item.

Did we mention, 2 design options are included in every package?

*Compare a cost-effective approach and an upgraded version
Price both with your contractor and choose what works best for your budget*



Material Board 4-piece bathroom upgraded

CABINETS/ VANITY

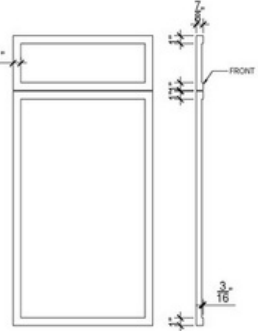
IMAGE	PRODUCT DETAILS	SUPPLIER CONTACT	NOTES
<p>Custom Cabinetry & Hardware</p>  	<p>Door Style Door Spe approval Grain Dir Sheen: S Cabinet C Drawer B Kick Mat Cabinet H Drawer s</p> <p>Cabinet H Main Pul</p>		

Choose between standard and custom options

Compare pricing and decide based on your priorities and budget

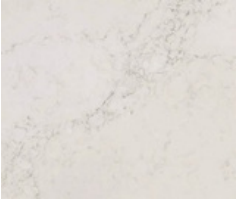
IMAGE	PRODUCT DETAILS	SUPPLIER CONTACT	NOTES
<p>Vanity Countertop</p> 	<p>Manufac Product N Finish: Po Thickness Edge Pro URL Link:</p>		

BATHROOM PLANNING GUIDELINE 1

SPA

Toile

.

.

Toile

.

.

Doub

.

Cour

.

Show

.

.

18" F

11"

asure
nce to

minimum

The key measurements and details most homeowners miss

BASED ON YEARS OF EXPERIENCE

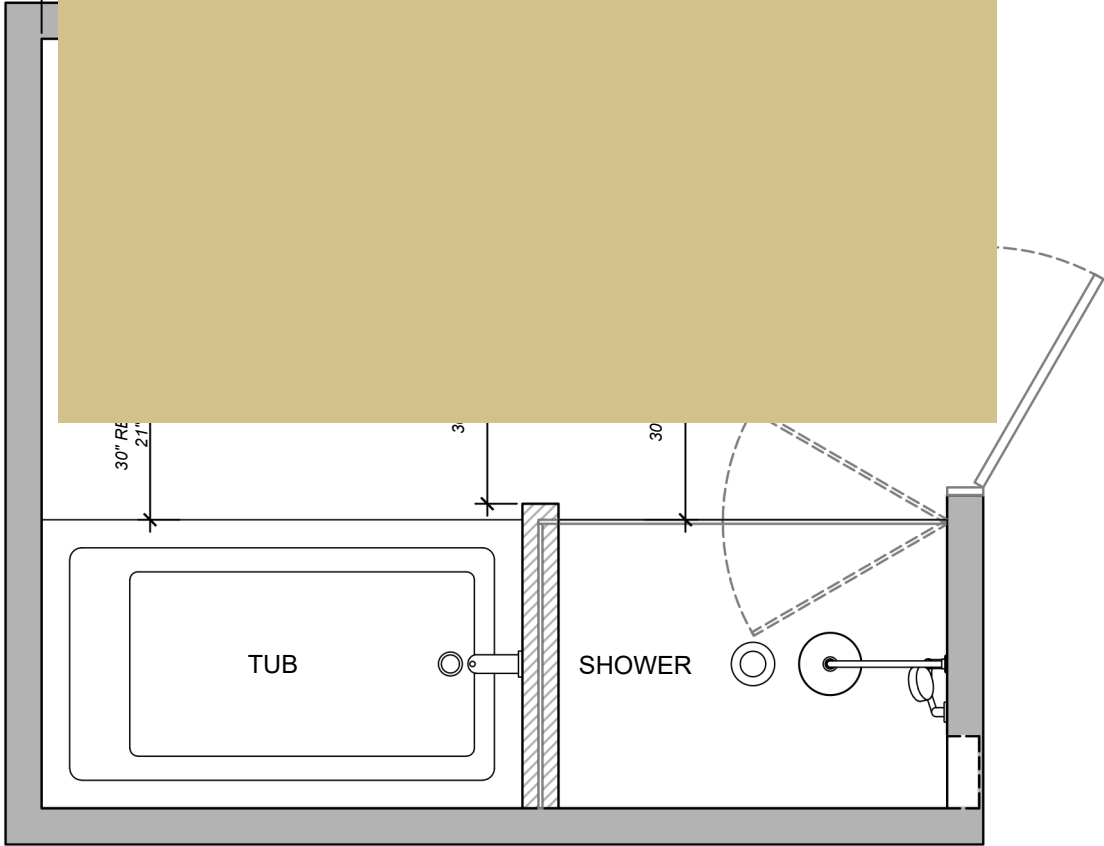

BATHROOM PLANNING GUIDELINE 4

Can be mo
face, minir
These fixtu
roughly ey
The center
or taller pe

Over-Mirror Lig
• The ideal l
extend ove
sconces. M

ss the
at
ceilings,
e.

t not
near

Includes 9 pages of practical
design guidance

For homeowners who want to understand the decisions, not just
follow a checklist

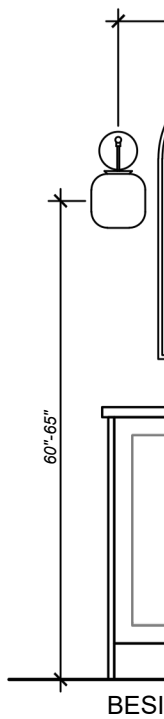

Details to know
• Check you

